

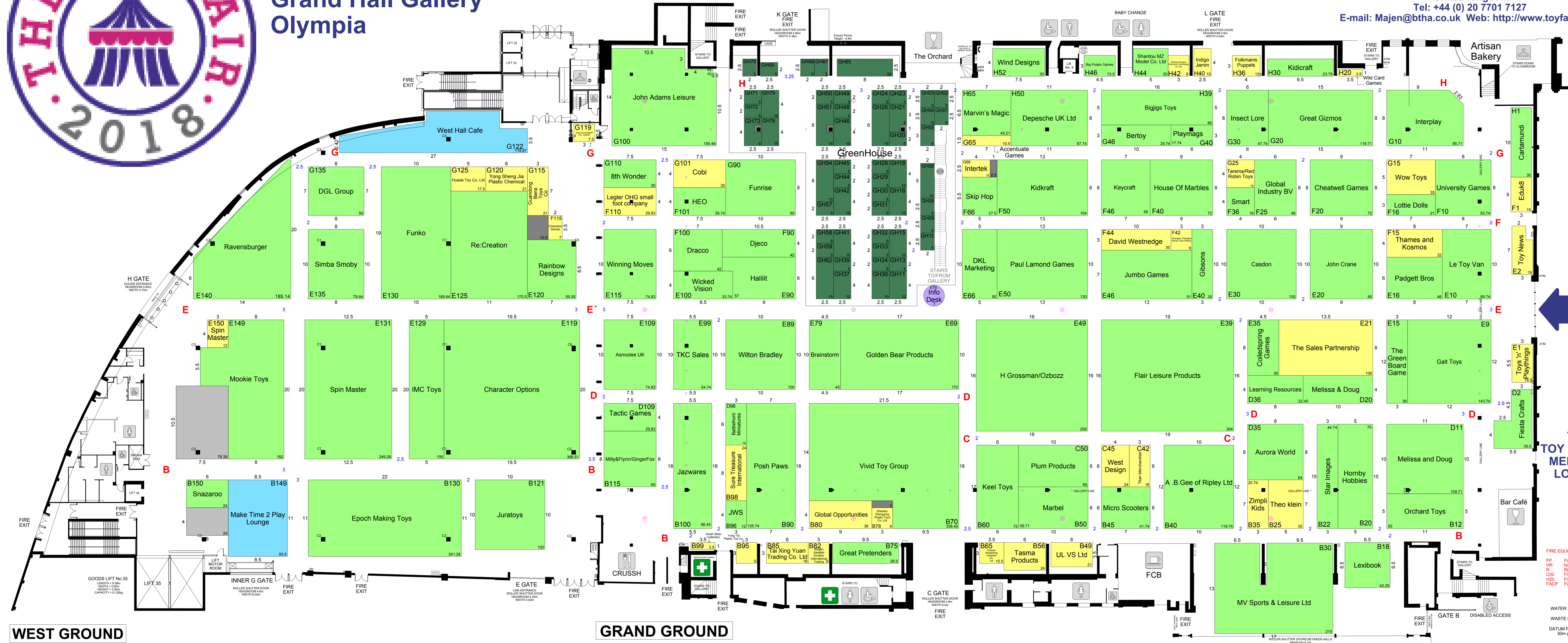

23 - 25 January 2018
Grand Hall Gallery
Olympia

ORGANISED BY:
THE TOY FAIR
British Toy & Hobby Association
BTHA House
142-144 Long Lane
London SE1 4BS
United Kingdom
Tel: +44 (0) 20 7701 7127
E-mail: Majen@btha.co.uk Web: http://www.toyfair.co.uk



SHADED AREAS ABOVE BASEMENTS

- Maximum uniform load: 3.2 tonnes per square metre
Maximum axle load: 1.2 tonnes per axle
- Maximum uniform load: 0.73 tonnes per square metre
Maximum axle load: 0.4 tonnes per axle
- Maximum uniform load: 2.15 tonnes per square metre
Maximum axle load: 0.8 tonnes per axle

GRAND & WEST HALL FLOOR LOADING INFORMATION

LOCATIONS APART FROM SHADED AREAS

- UNIFORMLY DISTRIBUTED LOADING (UDL)**
Maximum: 32kN per square metre
3.2 tonnes per square metre
672lbs per square foot
- VEHICLE WHEEL LOADING**
Maximum: 6.0 tonnes
Based on: Minimum track (axle length) of 1.8m
Minimum distance between axes of 1.0m at wheel centres
- POINT LOADING**
NB. This does not apply to loads over floor service ducts or the use of crane outriggers anywhere on the floor. See Notes 4 & 5.
Maximum: 6 tonnes at a minimum of 2.0m centres between loads, supported on a base of mild steel plate - 500mm x 500mm x 20mm thick
- CRANE OUTRIGGERS: IMPOSED LOADING**
Less than 9 tonnes on each outrigger, a base plate of 450mm will suffice.
- FLOOR SERVICE DUCTS: LOADINGS**
a) Uniformly distributed loading as per Note 1.
b) Vehicle wheel loading as per Note 2.
c) Point loadings anywhere on duct covers should be avoided. If this is absolutely unavoidable, the ducts must be fully bridged using a mild steel plate of 500mm x 500mm x 20mm thick. For loads up to 6 tonnes (13,220lbs) the point load must be imposed on the centre of the plate. Where the point load is not centred over the duct, the bridging plate must additionally extend to at least 250mm in length beyond the load point, to cross the nearest duct cover edge and so protect the floor surface.
- ALL PROPOSED LOADS IN EXCESS OF THE ABOVE LIMITS**
All such proposals must be individually accessed by Olympia's Consulting Engineers and approved by the Local Authority Engineer before written approval can be given. There will be a charge for these services, to be payable by the Event Licensee.

TYPICAL CROSS SECTION THROUGH GRAND HALL SECTION A - A

FIRE EQUIPMENT

- FP Fire Point
- HR Fire Hose Reel
- R Road
- C02 Fire Extinguisher - Carbon Dioxide
- H2O Fire Extinguisher - Water
- FACP Fire Alarm Call Point

WATER POINT

WASTE POINT

DATUM POINTS
30m grid

WEST GROUND

GRAND GROUND

Greenhouse Stand Names

GH01 Chemtrac	GH20 The Toy Project	GH39 Fandn International	GH62 Getretro.co.uk
GH02 Tractor Ted	GH21 Shantou Changhai Kunyang Trade Co.	GH40 Ugears Mechanical Models	GH65 Xiamen Chituo
GH03 PAGL	GH22 Eurofins	GH42 Green Elephant Trading	GH67 Teddybots
GH04 Savvy Games	GH24 Push it Games	GH44 Trido	GH68 Kooshi
GH05 EasyRead Time Teacher	GH26 Jumini	GH45 Simbrix - Connect & Wow	GH69 Playpress Toys
GH06 Hang Wing Plastic Industry	GH28 Muro	GH46 Bildy	GH70 OTL Technologies
GH08 Holibob Bear	GH29 Max Mindpower	GH48 Mojo Nation	GH71 Spiral Game
GH09 Little Boffins	GH30 AugmentifyIt	GH49 Rainbow Eco Products	GH72 Splendiferous Marketing
GH10 Aardvark Swift	GH31 Progressive Pre-School	GH50 Stems	GH73 Shantou City Bld Industrial Co. Ltd
GH11 A Girl For All Time	GH32 Pursuit nha	GH51 Chameleon Kidz	GH78 Taizhou Florish
GH13 Forever Collectibles	GH33 Keak Rungreang Co. Ltd	GH54 1 Two Kids	GH79 Braxies
GH15 Stepping Stones Marketing	GH34 Keak Japan Co. Ltd	GH57 Articulate Gallery	
GH16 Elf on the Shelf	GH36 Bureau Veritas	GH58 The MiniMaster Sports Company	
GH18 Creative Double Star	GH37 Toy World	GH59 Alphabet Pie	

- Unset
- Shell
- Space
- Feature
- Feature 2
- Green House
- Catering
- Store
- Venue column

Issue Number: 562
Issue Date: 05 Jan 2018
Updated by: Phil
Scale: N.T.S.

Hours allowance: <HOURSALLOWANCE>
Hours used: <HOURSUSED>
Hours remaining: <HOURSREMAINING>

© Global Experience Specialists (GES)
Floorplan subject to change

